

Surgery of Doctor Helga Raidl | Andreas Kanzian
Leopoldsdorf im Marchfelde | Austria | 2014



© Walter Lutzenberger

© Walter Lutzenberger

Wednesday
Mittwoch
Mercredi

27|01

Surgery of Doctor Helga Raidl | Andreas Kanzian
Leopoldsdorf im Marchfelde | Austria | 2014

After the demolition of a dilapidated, hook-shaped farm, which is typical of the region, a ground level, wheelchair accessible doctor's surgery covering approx. 225 m² of net floor space was constructed in the village centre of Leopoldsdorf im Marchfelde in just under seven months. The surgery's public area for patients surrounds an atrium-like inner courtyard, which separates the waiting area and the reception. The three examination rooms, including the therapy area, face the quiet, private courtyard. The ground level structure, which is somewhat lower due to the car park, follows the straight line of the row of houses on Kirchengasse and continues its closed form. Only the transparent zone of the main entrance and the gate, which is kept dark, provide accents in the otherwise very peaceful design of the house front.

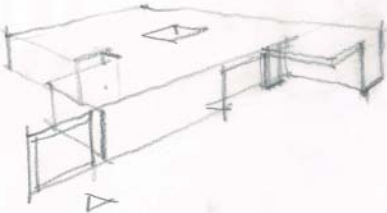

30 DAN/LEOPOLDSD M.
07.13