

GP surgery and outpatients`clinic of Dr. Kathrin and Dr. Bernhard Zöchmann I  
Ordinationsarchitektur Andreas Kanzian  
Neuhofen an der Ybbs I Austria I 2017



© Walter Luttenberger

Sunday  
Sonntag  
Dimanche

**19105**

GP surgery and outpatients`clinic of Dr. Kathrin and Dr. Bernhard Zöchmann I  
Ordinationsarchitektur Andreas Kanzian  
Neuhofen an der Ybbs I Austria I 2017

The two-storey, wheelchair-accessible facility includes GP surgery rooms on the ground floor, and a private operating theatre with adjoining rooms on the first floor. The lift and stairs are centrally located and connected to a two-storey atrium. While the surgery rooms tend to open outwards on all sides, the first floor is nearly completely enclosed, with light and fresh air provided by the two-storey atrium. The ground-floor surgery rooms include a reception area, the in-house dispensary, the waiting area, and four examination rooms with treatment area, laboratory, office and communal area. All rooms are grouped around the central atrium and allow internal and external access. The waiting area and reception area form a light-flooded centre. The topographical conditions necessitate a depression of the building in the slightly inclined terrain, and access via a ramp. During the entire construction period of 13 months – including a two-month winter break – the surgery continued to run undisturbed in a container, just a few metres away from the building. The extreme space limitations of the property made it necessary to build on top of part of the temporary container surgery

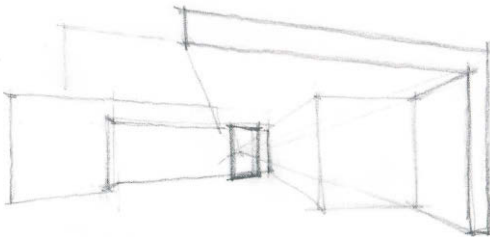

3. Hof Neuhofen  
07.15